



Deltech Furnaces

Product Overview 2021



Our Company

Deltech Furnaces

Thank you for the opportunity to introduce our company, Deltech, Inc. (Deltech Furnaces)

What we do:

We design and manufacture resistance heated laboratory and production scale furnace systems. Custom design is our specialty; we can meet the most demanding of application requirements.

Who we serve:

Materials science, glass, and petrology researchers and industrial ceramics and specialty glass manufacturers around the world.

We are an **ISO 9001:2015 certified** company, founded in 1968.

All control systems are certified ~~to~~ by **Intertek UL508A compliant**.



United States Customers Include:

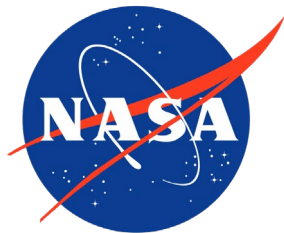

CORNING



Raytheon



COORSTEK



3M

Deltech Furnaces

Our Customers



Deltech Furnaces

Our International Customers Include:



Our Customers

2000°C

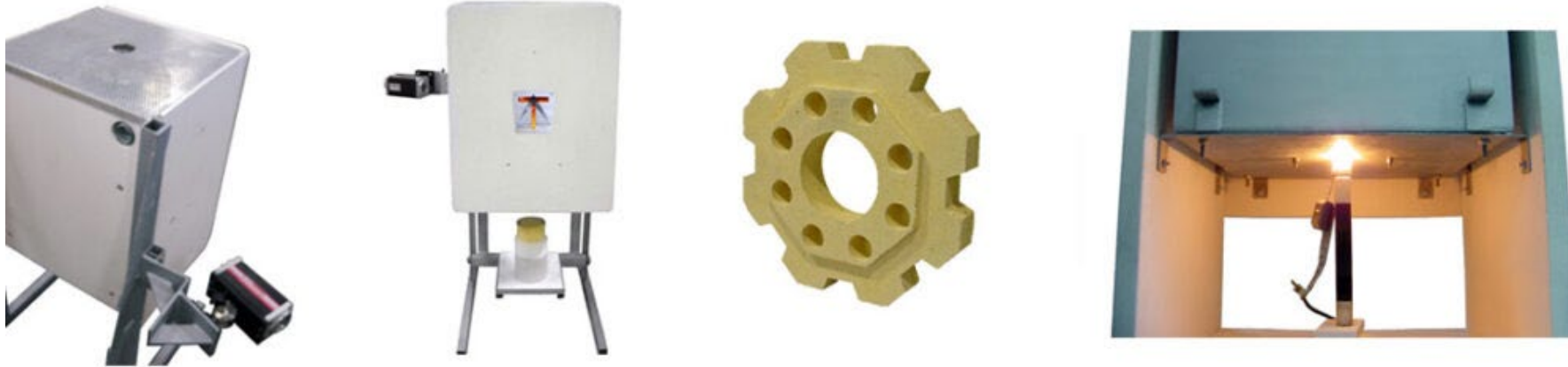

- » Operating temperatures up to 2000°C in air and in inert atmospheres
- » Two lab scale models primarily used for research and development purposes.
- » Customers include USACE, Johns Hopkins University, NASA.



- » Operating temperatures up to 1800°C in air and 1700°C in inert atmospheres
- » Both lab and production scale for use in R&D and in ceramic components production
- » Optional forced air and venting functions
- » Pneumatic and electric lifts
- » Customers include Coors Tek, Kyocera, and Northrup Grumman

Bottom Load

Deltech Furnaces





Deltech Furnaces

Front Loading



- » Operating temperatures up to 1800°C in air and to 1700°C in inert atmospheres
- » Both lab and production scale for use in R&D and in ceramic components production
- » Optional forced air and venting functions
- » Manual, pneumatic, and electric door operation designed to suit for each project
- » Customers include PCC Structurals, Heraeus, Honeywell, G.E. Aviation



- » Operating temperatures up to 1800°C in air and to 1700°C in inert atmospheres
- » Lab scale and “big batch” for specialty glass R&D and manufacture
- » Optional stirring systems including automated control
- » Special designs including such features as drain spouts for rapid quenching
- » Pneumatic and electric lifts

Glass Melt

Deltech Furnaces





Horizontal / Vertical / Combination HT/VT, and bottom loading Vertical Tube

Deltech Furnaces



- » Operating temperatures up to 1800°C
- » Optional gas mixing systems and tube plugs
- » Optional water cooled end caps (included on bottom loading vertical tube units)
- » Our vertical tube models are widely used in petrology labs for such applications as conducting oxygen fugacity studies
- » Customers include Academia Sinica, Cornell University, the Jet Propulsion Laboratory, Seoul National University, the University of Edinburgh

Materials Test



- » Operating temperatures up to 1800°C
- » Designed to be used in conjunction with tensile testing equipment
- » Custom designed and built to meet specific application requirements
- » Customers include GE Global Research, NASA, Battelle





Deltech Furnaces

Positive Pressure



- » Operating temperatures up to 1700°C
- » Operating pressures up to 1500 psi
- » Custom designed and built to meet specific application requirements
- » Customers include the National High Magnetics Laboratory at Florida State University

Rocking/Oscillating Motion

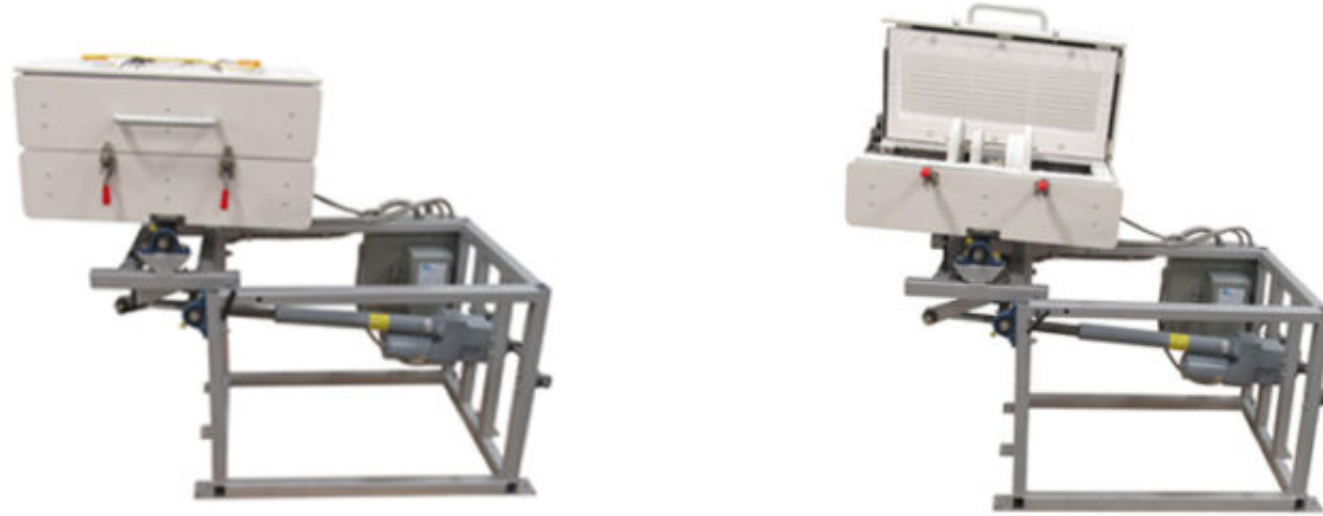

- » Operating temperatures up to 1600°C
- » Custom designed and built to meet application requirements
- » One application is stirring while heating the contents of ampoules containing glasses
- » Customers include Battelle and Teledyne Energy

- » Operating temperatures up to 1700°C
- » Sizes from benchtop to small scale production
- » Customers include Corem, HPCL, Sandia National Laboratory
- » Custom designed and built to meet specific application requirements
- » One application is continuous powder processing in inert atmospheres



Rotary Tube

Deltech Furnaces





Deltech Furnaces

Top Hat



- » Operating temperatures up to 1800°C in air and 1700°C in inert atmospheres
- » Both lab and production scale for use in R&D and in ceramic components production
- » Optional forced air and venting functions
- » Pneumatic and electric lifts
- » Customers include Coors Tek, Battelle, Corning, Saint-Gobain

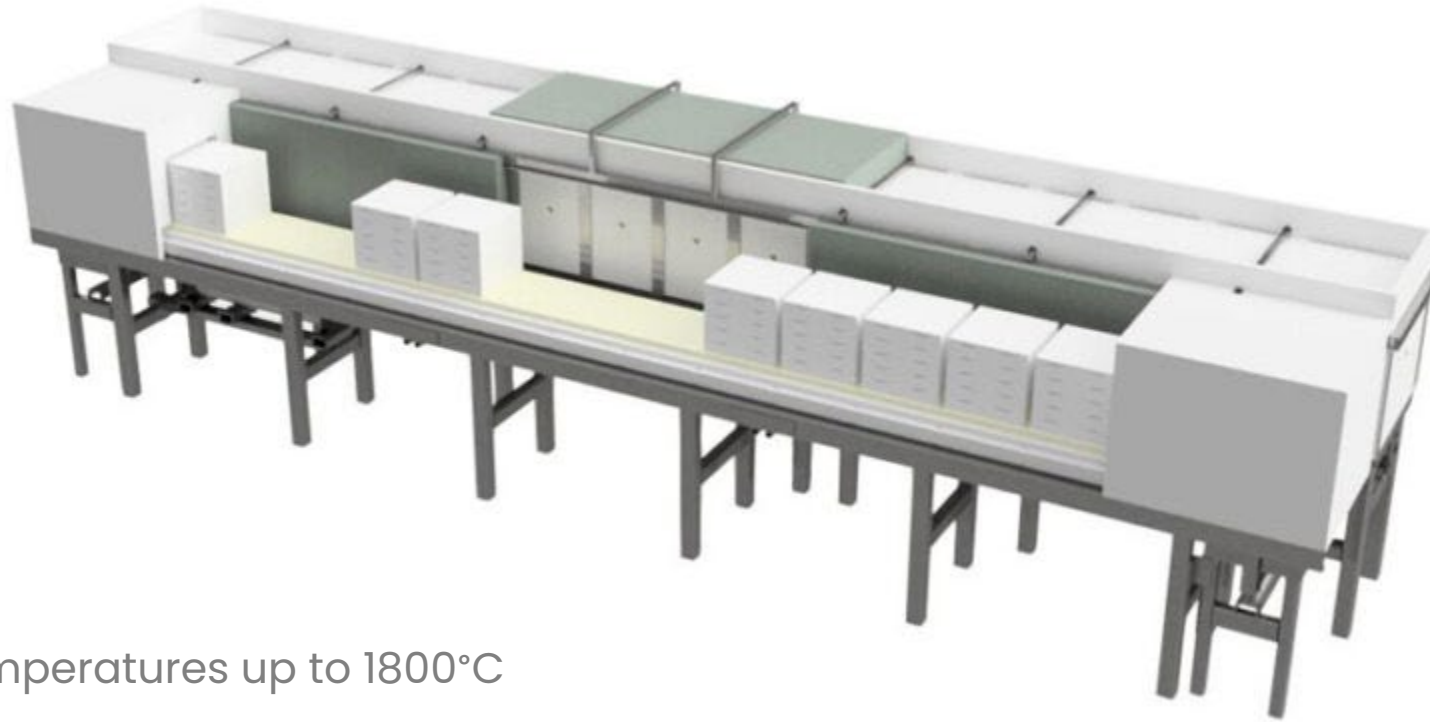

- » Operating temperatures up to 1800°C
- » Ideal for scaling up from laboratory size while maintaining temperature uniformity impossible in large gas fired kilns
- » Customers include Robocasting, Inc.

Tunnel Kiln

Deltech Furnaces



Spare Parts

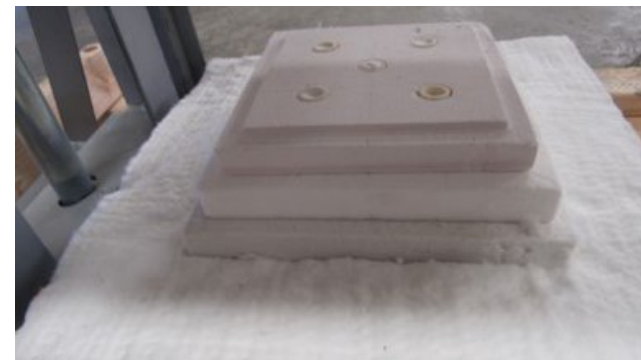

- » Reline insulation parts and kits
- » Heating elements
- » Element accessories such as holders and straps
- » Thermocouples
- » Ceramic components such as hearth plates

.



Custom design and builds to meet the most exacting and demanding application requirements are our specialty.

